

### Valvola a sfera RS maschio girella DIN - garolla

RS ball valve DIN nut and liner - garolla end

RS Kugelventil DIN KM - Garolla

Vanne à boule RS femelle DIN - garolla

Válvula de bola RS tuerca DIN - garolla

DN	A	B	C	D	E	F
40	127	40	40	40	64	185
50	137	50	50	50	68	185
60	150	60	60	60	73	205
70	161	70	65	70	95	243
80	180	80	80	80	104	243
100R	187	100	100	90	111	243
100	204	100	100	100	122	273
125	225	120	125	120	135	273
150	246	188	190x1/4"	136	148	273

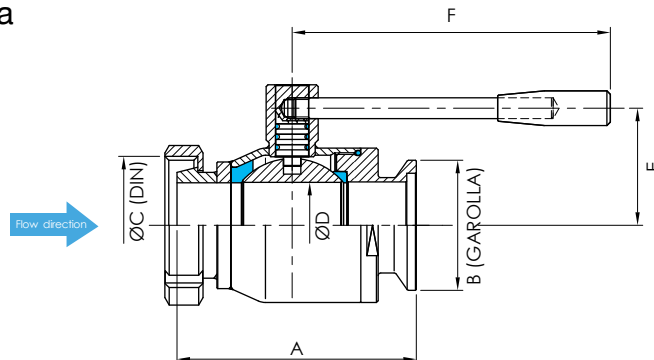

### Valvola a sfera RS flangia PN10 - garolla

RS ball valve PN10 flange - garolla end

RS Kugelventil PN10 Flansch - Garolla

Vanne à boule RS bride PN10 - garolla

Válvula de bola RS brida PN10 - garolla

DN	A	B	C	D	E	F	G	H	L
40	107	40	110	40	64	18	150	4	185
50	117	50	125	50	68	18	165	4	185
60	130	60	145	60	73	18	185	4	205
70	141	70	145	70	95	18	185	4	243
80	156	80	160	80	104	18	200	4	243
100R	162	100	160	90	104	18	200	4	243
100	181	100	180	100	122	18	220	8	273
125	201	120	210	120	135	18	250	8	273
150	222	188	240	136	148	22	285	8	273

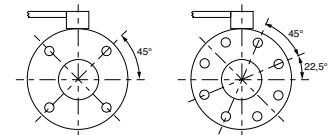
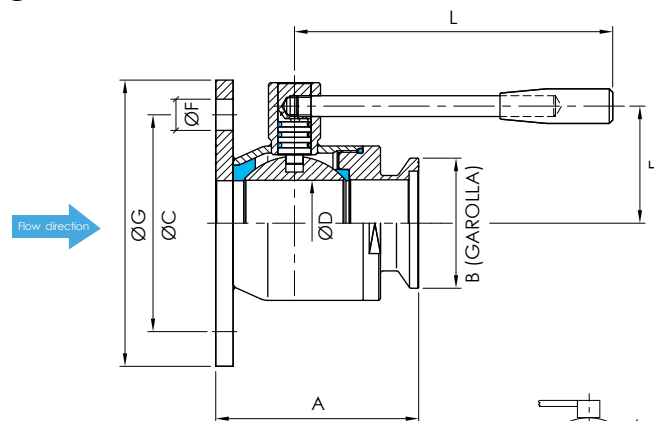
 Posizione dei fori flangia rispetto alla valvola  
 Position of the flange holes welded to the valve

### Valvola a sfera RS flangia per cemento - garolla

RS ball valve reduced for cement flange - garolla end

RS Kugelventil Flanschansatz für Zement - Garolla

Vanne à boule RS bride pour béton - garolla

Válvula de bola brida por cemento - garolla

DN	A	B	C	D	E	F
40	107	40	42.4	40	64	185
50	117	50	60	50	68	185
60	130	60	63	60	73	205
70	141	70	76.1	70	95	243
80	156	80	88.9	80	104	243
100R	162	100	101.6	90	104	243
100	181	100	104	100	122	273
125	201	120	129	120	135	273
150	222	188	154	136	148	273

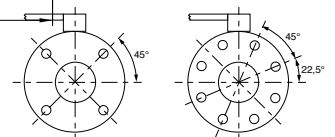
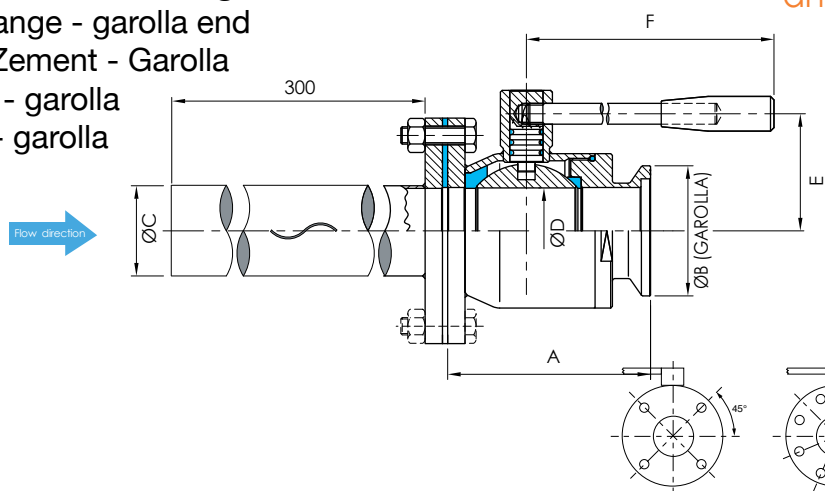
 Posizione dei fori flangia rispetto alla valvola  
 Position of the flange holes welded to the valve